

Zaro HSK50 // Shaft ø20 mm // RS ø50 mm

Fitted to Zaro tool grinding machines with ring set ø50 mm

GWA HSK50 // ø20 mm // RS ø50 mm

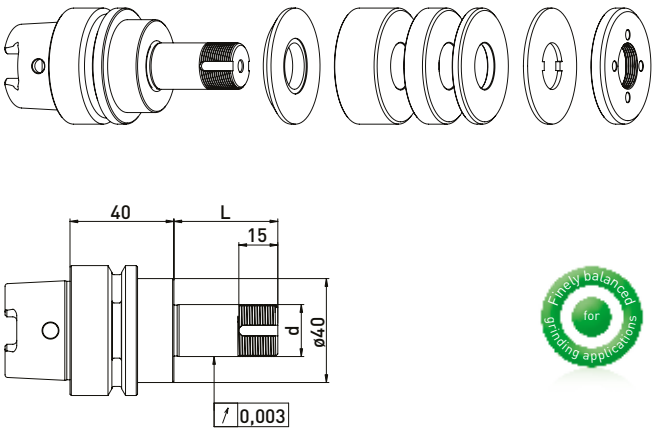

Delivered equipped:
Reducing washer, ring set ø50 mm, lock washer and clamping nut

Ring set ø50 mm						
Order No.	HSK	d	L	B 20	B 10	B 4
300112012	HSK50	20	40	-	1	3
300112022	HSK50	20	60	1	1	3
300112032	HSK50	20	75	1	2	4
300112042	HSK50	20	85	2	1	4
300112052	HSK50	20	100	2	3	3

GWA HSK50 // ø20 mm // without RS

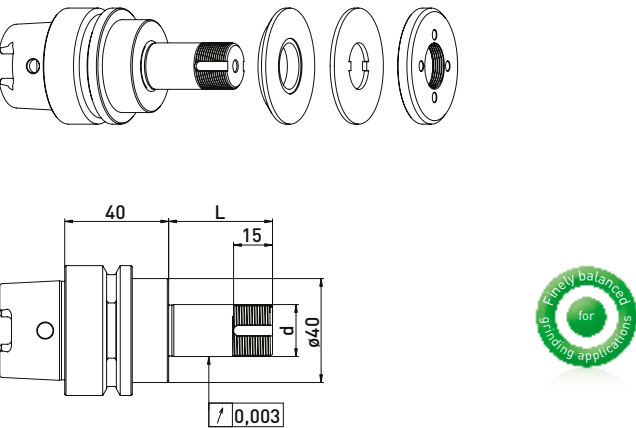

Delivered equipped:
Reducing washer, lock washer and clamping nut

Order No.	HSK	d	L
300112011	HSK50	20	40
300112021	HSK50	20	60
300112031	HSK50	20	75
300112041	HSK50	20	85
300112051	HSK50	20	100

Accessories Zaro grinding wheel adapter HSK50 // Shaft ø20 mm // Ring set ø50 mm

Order No.	Name
350050010	Universal assembly device ø50
350040010	*Clamping nut wrench PC27 for ø20
350040011	*Clamping nut wrench PC27 for ø20
350020021	*Balancing weight pair for clamping nut ø50 // 100gmm

Order No.	Name
350011020	Spacer ring ø50 x ø20 x 20
350011010	Spacer ring ø50 x ø20 x 10
350011004	Spacer ring ø50 x ø20 x 4
350015002	Reducing washer ø40 x ø50 x ø20 x 6
350030010	Lock washer ø50 x ø20 x 2
350020060	Clamping nut ø50 x 6 x M20 x 1 PC27
350020020	*Clamping nut with balancing option ø50 x 8,5 M20 x 1,0 PC27

Adapters for dressing, presetting etc.

Adapter piece for tool grinding machines, dressing machines, presetting devices, balancing machines

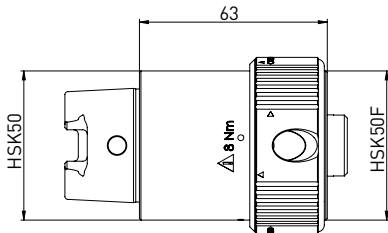

Order No.	Name
350130020	Adapter piece HSK50 on HSK40 A/C/E HSK50 B/D/F

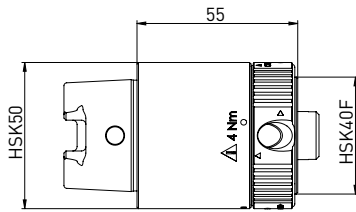

Order No.	Name
350130021	Adapter piece HSK50 on HSK32 A/C/E HSK40 B/D/F

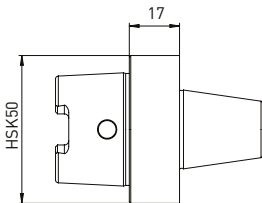

Order No.	Name
350130034	Adapter piece HSK50 on ANCA taper ø30

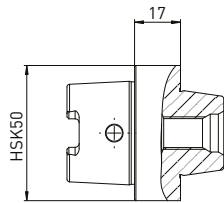

Order No.	Name
350130032	Adapter piece HSK50 on Haas/Walter taper

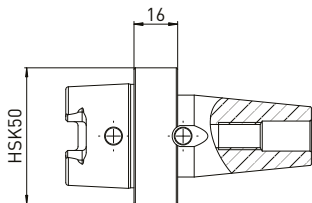

Order No.	Name
350130030	Adapter piece HSK50 on Strausak Fleximat

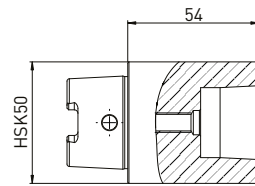

Order No.	Name
350130031	Adapter piece HSK50 on Strausak Promat

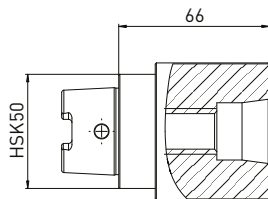

Order No.	Name
350130033	Adapter piece HSK50 on Saacke short taper

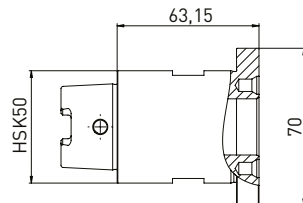

Order No.	Name
350130048	Adapter HSK50 x ø25 on Rollomatic

Adapter for dressing, presetting, balancing

Adapters fine balanced SK40 and SK50 for tool grinding machines, dressing machines, presetting devices, balancing machines

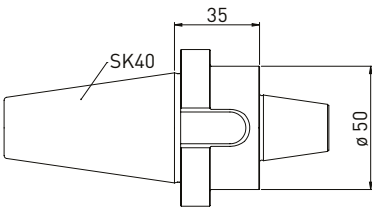

Order No.	Name
350130035	Adapter SK40 on ANCA taper ø30

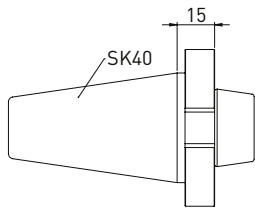

Order No.	Name
350130014	Adapter SK40 on Haas/Walter taper

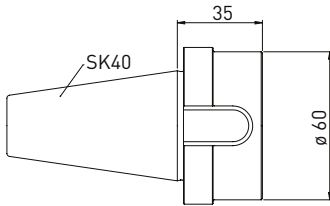

Order No.	Name
350130040	Adapter SK40 on Saacke short taper

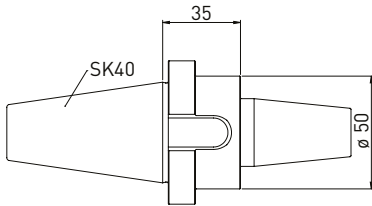

Order No.	Name
350130043	Adapter SK40 on Strausak Fleximat

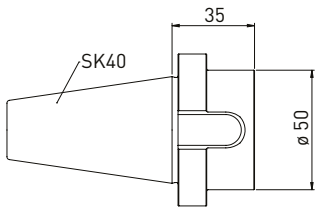

Order No.	Name
350130042	Adapter SK40 on Strausak Promat

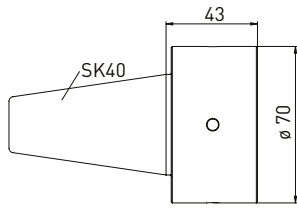

Order No.	Name
350130039	Adapter SK40 on Rollomatic ø25

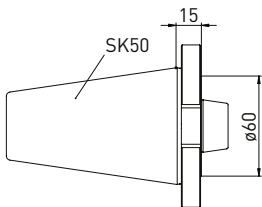

Order No.	Name
350130044	Adapter SK50 on Haas/Walter taper L15

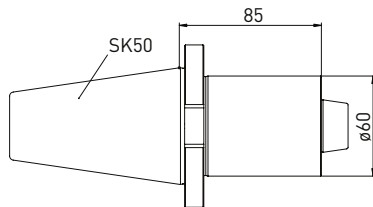

Order No.	Name
350130045	Adapter SK50 on Haas/Walter taper L85

Adapters SK40 and SK50 on HSK tool adapters

Adapter SK40 on HSK

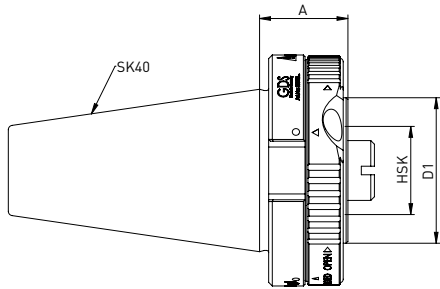

Order No.	A/C/E HSK shape	B/D/F HSK shape	A	D1
350130011	HSK32	HSK40	25	40
350130012	HSK40	HSK50	35	50
350130013	HSK50	HSK63	45	63

Adapter SK50 on HSK

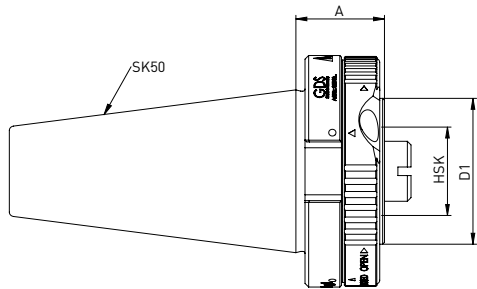

Order No.	A/C/E HSK shape	B/D/F HSK shape	A	D1
350130001	HSK32	HSK40	30	40
350130002	HSK40	HSK50	33	50
350130003	HSK50	HSK63	45	63

Adapters for grinding wheel adapters from ø20 to ø10 // and ø20 to ER16 collet chuck

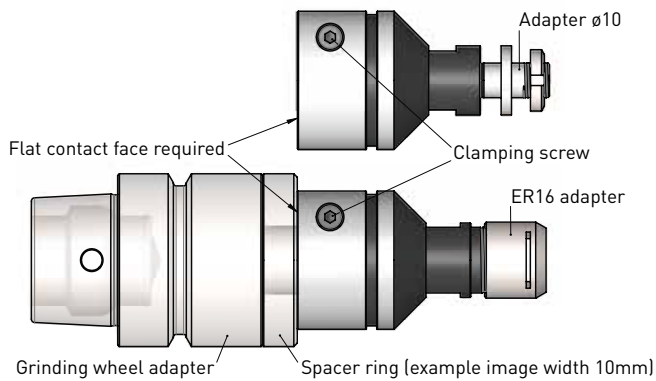

Assembly example

Twist adapter onto M20 x 1 screw and bring to rear to flat contact face.

If needed, lay spacers down first so that the adapter meets the flat contact face.

Subsequently, tighten using spanner flat and secure with clamping screw.

Adapter ø20 on ø10

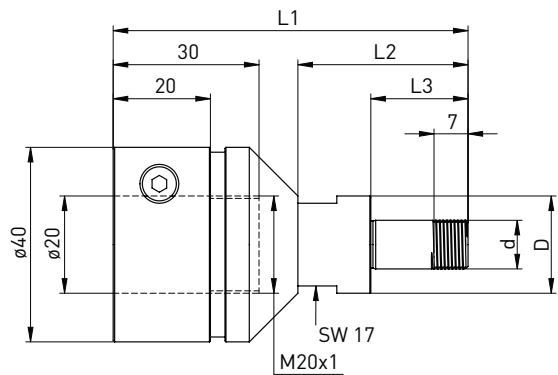

Delivered equipped:
Clamping nut (350020114), Spacer rings 4pc. (350016004)

Order No.	D	d	L1	L2	L3
350130046	20	10	73	35	20

Accessories Adapter ø20 on ø10

Order No.	Name -ø
350016004	Spacer ring ø20 x ø10 x 3
350020114	Clamping nut ø18 x 4 - M10 x 0,75
350040050	Hook wrench 16-20 mm

Adapter ø20 on ER16

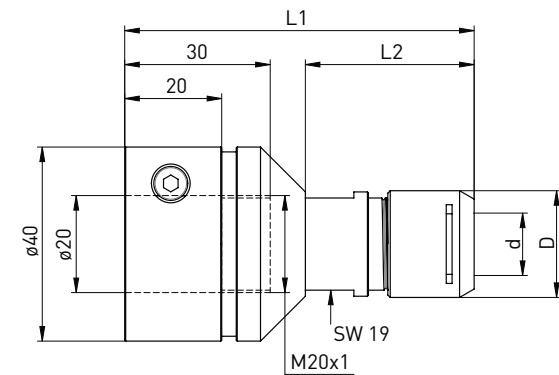

Delivered equipped:
Mini clamping nut Silent ER16 (350020116)

Order No.	D	d	L1	L2
350130047	22	ER16	76	34

Accessories Adapter ø20 on ER16

Order No.	Name
350125116	Mini clamping nut SILENT ER16
350126116	Clamping wrench for Mini clamping nut SILENT ER16

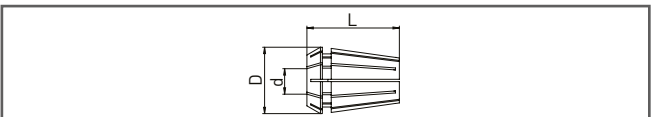

Order No.	Name
3501217**	Collet DIN 6499 ER16 **ø1-10mm
**[Please complete the order number with the two-digit number that defines the diameter!] e.g. for ø1 -> last digit 01 (350121701) for ø10 last digit ->10 (350121710)	

HSK50 Test and angle dial

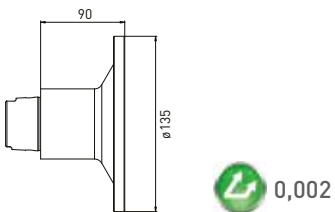

Order No.	Name
350090010	Test and angle dial HSK50

HSK40 Test and angle dial

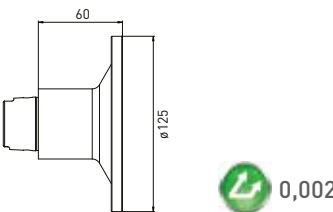

Order No.	Name
350090020	Test and angle dial HSK40

Test and angle dial

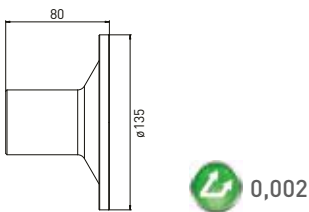

Order No.	Name
350090030	Angle dial Haas/Walter taper 31.75

SK Test mandrel

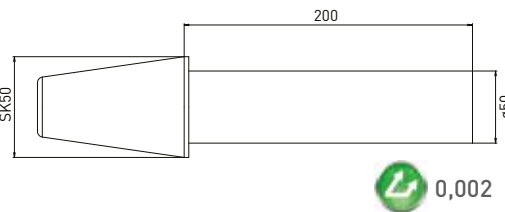

Order No.	Name
350090040	Test mandrel SK50 x ø50 x 200

HSK Test mandrel

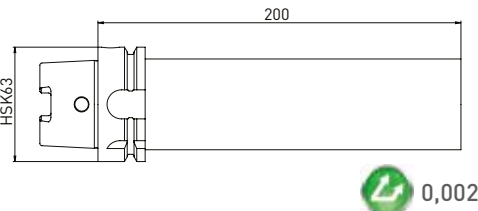

Order No.	Name
350090050	Test mandrel HSK63 x ø50 x 200

HSK Test mandrel

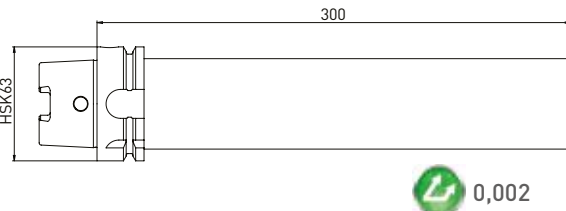

Order No.	Name
350090060	Test mandrel HSK63 x ø50 x 300